

**Historic Preservation Commission Meeting
City Hall - Council Chambers**

June 24, 2026

6:30 PM

Agenda

PUBLIC NOTICE

In accordance with the Statutes of the State of Illinois and the Ordinances of the City of Highland Park, a Special Meeting of the Historic Preservation Commission of the City of Highland Park is scheduled to be held at the hour of 6:30 PM on Wednesday, June 24, 2026, at City Hall - Council Chambers, 1707 St Johns Avenue, Highland Park, Illinois, during which meeting it is anticipated that there will be a discussion of the following items.

The Historic Preservation Commission has elected to conduct the meeting entirely in-person, and without opportunity for virtual viewing or participation. Please contact the Department of Community Development – Planning Division at (847) 432-0867 for up-to-date information on the conduct of the meeting.

Individuals with questions or feedback about an agenda item may email the Staff Liaison Maddy Markle at mmarkle@cityhpil.com. Comments and emails received prior to the Thursday before the scheduled meeting will be included in the meeting packet. Public comments received by 4:30 PM the day of the meeting will be read under Business from the Public. Any comments received during the meeting will be held until the end of the meeting. Individuals who wish to have their comments read into the public record are limited to 200 words or less. Public comments should be emailed and contain the following information:

- In the subject line, identify, “HPC (Date of Meeting)”
- Name
- Address (optional)
- City
- Phone (optional)
- Organization, agency representing, if applicable
- Topic or agenda item number of interest

All emails received will be acknowledged. Individuals with no access to email may leave a voice message with Maddy Markle at 847.926.1856.

The City, in compliance with the Americans with Disabilities Act, requests that persons with disabilities who require certain accommodations to allow them to observe and/or participate in this hearing, or who have questions about the accessibility of the meeting facilities, [email the City’s ADA coordinator Emily Taub](#) or call at 847.926.1005.

- I. Call to Order**
- II. Roll Call**
- III. Approval of Minutes**
- IV. Scheduled Business**
- V. Discussion Items**
 - A. Place of Remembrance Design Concept
- VI. Business from the Public (Individuals wishing to be heard regarding items not listed on this agenda)**
- VII. Other Business**
 - A. Next Regular Meeting to Occur July 9, 2026
- VIII. Staff Report**
- IX. Adjournment**

Staff Report



Meeting Date: June 24, 2026

Staff Contact: Emily Taub, Assistant City Manager
Jazmin Alejandro, Social Services Specialist
Maddy Markle, Planner I
Zubin Coleman, Senior Planner
Amanda Bennett, Communications Manager

Department: City Manager's Office

Title: Place of Remembrance Design Concept

Recommendation:

Staff recommends the Historic Preservation Commission discuss the relationship between the Place of Remembrance unified design concept and the locally landmarked Rose Garden site.

Policy Consideration:

Background

In 2023, the City Council established a Working Group to guide the planning process for the permanent Place of Remembrance for the Highland Park shooting. The Place of Remembrance has three primary objectives:

- Create an accessible public place for reflection, remembrance, and solace;
- Pay tribute to the memories of Katie Goldstein, Irina McCarthy, Kevin Michael McCarthy, Jacki Lovi Sundheim, Stephen Straus, Nicolas Toledo, and Eduardo Uvaldo;
- Honor the community's resiliency, especially those who were injured.

The Working Group has been meeting regularly since November of 2023, with all meeting notes and related documents available online at hpremembrance.org/meetings. Key milestones for the Working Group include:

- Potential location brainstorm and development of the location shortlist (Port Clinton Square, the southwest corner of St. Johns & Central, the Rose Garden): [February 27, 2024](#) & [April 3, 2024](#)
- RFP process for location feedback focus group & survey consultants: [August 27,](#)

[2024](#) (firm recommendation); October 15, 2024 ([Council approval](#))

- Location feedback public engagement process: November 2024 - January 2025; [March 31, 2025](#) (Working Group presentation); [April 14](#) & [April 25](#) (Committee of the Whole presentation); [Full downloadable report](#) recommending a prominent, primary Place of Remembrance at the Rose Garden and a subtle, secondary location at Port Clinton Plaza
- RFQ process for design services, a multi-phase process: April 30, 2025 (RFQ issued); [June 18, 2025](#) (shortlist developed for interviews & representative designs); [August 27, 2025](#) (Working Group recommendation); [October 6, 2025](#) (Committee of the Whole discussion and selection of SWA Group); [December 15, 2025](#) (Committee of the Whole update and budget determination); [January 12, 2026](#) (approval of agreement with SWA Group)

Design Process Overview

In January, 2026, the City entered into an agreement with SWA Group for the design of the permanent Place of Remembrance, including the prominent primary location at the Rose Garden, and the subtle, secondary location at Port Clinton Plaza. The design and construction process is divided into [five phases](#) discussed in detail, with milestones, [on the City's website](#).

The first phase, Ideation, represented an opportunity for the design team to meet the community and hear feedback on potential design elements through a comprehensive public engagement strategy developed by SWA Group's partner consultant, All Together. Working in partnership with City staff, SWA Group and All Together implemented a tiered approach to this phase of community engagement in line with that of the [Location Feedback Survey](#) (2025; see below) and the Place of Remembrance [communications plan](#) (see *Attachment 6*). Feedback during the Ideation phase focused on mood boards and open-ended questions to help the team actively develop ideas and concept designs from community feedback (see *Attachment 7*). This phase entailed ideation listening sessions from victims' families, individuals who were injured, and first responders, focus groups with various stakeholders, including parade participants, government and resource partners and others who assisted with the shooting response, including City staff, a listening session at the Committee of the Whole (February 23, 2026), a community workshop, and a public survey. This phase also included an initial joint conversation between the Committee of the Whole and the Historic Preservation Commission, with respect to considerations pertaining to the historic landmark at the Rose Garden on [March 9, 2026](#).

The Ideation phase resulted in the three design concepts that were presented at a public meeting of the Working Group on May 7, 2026 and at the Council design concept listening session at the Committee of the Whole on May 11, 2026. The engagement report summarizing quantitative and qualitative feedback received is [available](#) on the City's website.

The second phase, Design Concepting, began in May and will continue throughout June. During Design Concepting, the design team presented the three concept designs informed by the public engagement from the Ideation phase to the community to receive feedback on the concepts. Individual outreach to victims' family members and people who were injured was conducted by the Resiliency Division and in person listening sessions were held with the design team. Public

workshops were held on May 9 and May 11 in addition to multiple opportunities to view the concepts at City Hall, the Highland Park Senior Center, and Moraine Township to reach and receive input from the community. A community wide survey was also conducted online and in paper format.

An engagement report summarizing the information shared by victims and the community is available on the City's website. The comprehensive feedback informed the development of a single unified design concept which was shared with the City Council on [June 8](#) (see *Attachment 8*).

Subsequent design phases will include Design Development (anticipated July - September 2026), Construction Documentation (anticipated September - December 2026), and Construction (anticipated 2027 - completion) – information on these phases is [available](#) on the City's website. The construction timeline will be developed after the final design is determined and a construction manager has been onboarded. RFP responses for construction manager services were due June 5, 2026.

Previous Commission Discussion

The [March 9, 2026](#) Joint Special Meeting of the Committee of the Whole and the Historic Preservation Commission included a review of the historic elements of the Rose Garden. The report and meeting the history, historic landmarking process, and current status of the site. At that meeting, the Committee of the Whole and the Historic Preservation Commission discussed considerations pertaining to the Place of Remembrance and the Rose Garden.

Site History

Laurel Park, the location of the Rose Garden, was acquired by the Park District in 1930. The Men's Garden Club of Highland Park engaged notable landscape architect Marshall J. Johnson, who was the son-in-law of Jens Jensen, to design Gardeners Memorial on the site of Laurel Park. Upon completion in 1942, Gardeners Memorial was presented to the City. The garden was designed as a commemoration of three Highland Park citizens who were instrumental in the development of Highland Park's landscape heritage. The park design has three main components which relate to the principles of the man it honors: the rose garden in honor of William C. Egan, Highland Park's first rosarian; a wildflower garden at the northeastern third of the park to honor Jessie Lowe Smith, a naturalist and local educator; and Players Hill at the southeastern section of the park in honor of Jens Jensen, naturalist and landscape architect. The site was designated a Local Landmark in 1992 (see *Attachment 1*).

Staff has investigated the historic record and visited the site to determine which historic site elements are still intact. Staff concludes the site once resembled the 1942 Marshall Johnson Plan (see *Attachment 2*) but has been gradually altered over time. The following is an analysis of the three primary components of Gardeners Memorial.

William Egan Rose Garden – Central Portion of Lot

The Rose Garden was implemented as depicted by the Marshall Johnson plan and has largely retained its layout. However, many of the original roses planted in the garden did not adapt well to the climate through the years and have been replaced with hardy varieties. There was once a

pool of water at the center of the Rose Garden, but the pool was filled in between 1942 and 1988. In 2008 a rain garden was installed in front of the Rose Garden.

Jesse Lowe Smith Wildflower Garden – Northeast Portion of Lot

This portion of the site is marked by a stone that reads “Jesse Lowe Smith Native Garden.” The wildflower garden was originally intended to include a sizeable pool and council ring. However, the council ring was never implemented. According to the 1988 Landscape Survey (see *Attachment 4*), Johnson installed a stone sundial bench in place of the council ring. The pool was implemented but filled in between 1942 and 1988. An original stone retaining wall marks where the pool once stood. In 1959, Forest King, created by artist Abbott Pattison, was installed above the 1942 retaining wall.

Jen Jensen’s Player’s Hill – Southeast Portion of Lot

This portion of the site is marked by a stone that reads “Jens Jensen Native Garden.” The original design was not maintained, and as a result, the Player’s Hill retains little integrity of design.

Staff concludes the site’s remaining historic features are the Rose Garden in its entirety, the stone sundial bench, and the stone retaining wall. The Rose Garden, sundial bench and stone retaining wall are confirmed to have existed in 1992. These features were known to the Historic Preservation Commission at the time of the Landmark Designation. The other site features depicted in the Marshall Johnson plan were either never implemented or do not retain sufficient integrity of design.

Next Steps

Staff recommends that the Historic Preservation Commission discuss the interaction between the Place of Remembrance design concept and the locally landmarked Rose Garden site. SWA will give a presentation explaining the relationship between the design and the history of the site. The City will submit an application for a Certificate of Appropriateness (“COA”) in the Fall, once construction documents are drafted.

Core Priorities:

Fiscal Stability

The engagement of Do Tank for the location feedback survey and focus group facilitation was \$45,000.

The cost of the first stage of SWA's service agreement (project administration; listening, discovery, and community engagement; schematic design) is \$262,500 plus up to \$21,000 in reimbursable expenses (8% of the costs). The estimate provided by SWA for the second stage (design development; construction documentation; construction administration) is \$700,000 - \$1,250,000. The final determination on stage two costs is being refined following the unified design and is anticipated to be presented to City Council on June 29, 2026.

The City Council supported a preliminary budget of \$2 million for construction of the Place of Remembrance. At the June 8, 2026 Committee of the Whole meeting, the City Council supported an updated budget of \$2.3 - \$2.8 million for the Rose Garden site with Port Clinton costs under development. Although Council direction was not to pursue active fundraising due to

the broad impact of the shooting on the community, the City has received several donations to support this project, most notably a restricted gift of \$1 million from Jon & Mindy Gray among other similarly directed gifts for the Permanent Place of Remembrance.

Public Safety

The design concepts incorporate best practices for public safety and accessibility, including preservation of sightlines and hardscapes that support visitors who may be using mobility devices or pushing strollers.

Infrastructure Investment

The permanent Place of Remembrance will incorporate a primary installation at the Rose Garden and a subtle, secondary installation at Port Clinton Plaza. While the scale and nature of the designs will be different, each represents a significant infrastructure undertaking given the presence of existing structures at or adjacent to the site.

Environmental Sustainability

The design concepts take the City's commitment to environmentally sustainable practices into consideration through recommendations for native plantings and seasonality.

Attachments:

1. Attachment 1. Laurel Park Gardeners Memorial Park Landmark Information
2. Attachment 2. Marshall Johnson Plan
3. Attachment 3. 1986 Survey
4. Attachment 4. 1988 Historic Landscape Survey
5. Attachment 5. Rose Garden Existing Conditions
6. Attachment 6. Place of Remembrance Communication Plan April 3, 2024
7. Attachment 7. Ideation Engagement Summary May 7 2026
8. Attachment 8. Unified Design Concept Presented at June 8 Special COTW

Highland Park Historic Preservation Commission
1707 St. Johns Avenue
Highland Park, Illinois 60035

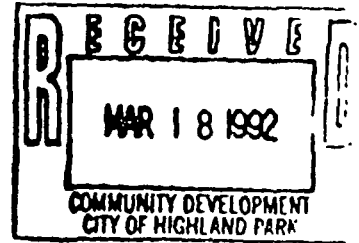

Landmark Nomination Form

Date: 3/16/92

1) Name of Property (original if known): Laurel Park & Gardener Memorial

2) Street Address: 494 Laurel/1707 St. Johns Avenue, Highland Park, IL 60035

3) Legal description or P.I.N. (Permanent Index Number from Township Assessor's Office, 600 Laurel Ave., Highland Park): _____

PIN 16-23-413-018 16-23-413-019

4) Name and Address of Property Owner(s) (From Assessor's Office): _____

Park District of Highland Park

636 Ridge Road, Highland Park, IL 60035

5) Present Use: Park 6) Past Use: Park

7) Architect: Marshall Johnson 8) Date of Construction: 1942

9) Written statement describing property and setting forth reasons it is eligible for Landmark designation:

Laurel Park and Gardeners Memorial was presented to the City by the Men's Garden Club in 1942. It was designed by Johnson, Jens Jensen's son-in-law, and commemorates three citizens who were instrumental in the development of Highland Park's landscape heritage; Jessie Lowe Smith, naturalist and educator. William Egan, Highland Park's 1st rosarian, and Jens Jensen, naturalist and landscape architect. Each part of the park relates to the principles of the man it honors.

10) This structure is eligible for designation on the basis of the following criteria (see reverse page):

1, 3, 5, 7, 8

11) Name(s) and Address(es) of Applicant(s):

Name(s): Ralph Cianchetti

Signature(s): _____

Ralph Cianchetti

Address(es): 636 Ridge Road
Highland Park, IL 60035

12) Affiliation (Commission Member, Owner, City Council, Preservation Organization):
President, Board of Park Commissioners, Park District of Highland Park

Please complete and return this form to the Highland Park Preservation Commission 1707 St. Johns Avenue, Highland Park, Illinois 60035

AN ORDINANCE DESIGNATING HIGHLAND PARK LANDMARKS

WHEREAS, the Historic Preservation Commission of the City of Highland Park, pursuant to Section 24.025 of "The Highland Park Code of 1968", as amended, did conduct a public hearing on April 16, 1992, pursuant to proper notice; and

WHEREAS, following said hearing, the said Historic Preservation Commission passed Resolution No. 05-92 (a copy of which resolution is attached hereto and made a part hereof as Exhibit I), which resolution contains the report of the Commission as well as a recommendation to the City Council of the City of Highland Park that Laurel Park and Gardeners Memorial Park (hereinafter referred to as "Subject Property") be designated Highland Park Landmarks; and

WHEREAS, the City Council has determined that the designation of the Subject Property will be consistent with the planning policies and objectives of the City, will promote the welfare of its residents, and will not adversely affect the value, use, or enjoyment of any adjacent or nearby property; and

WHEREAS, the City Council of the City of Highland Park believes it to be in the best interests of the residents of the City of Highland Park that the Subject Property be designated as Landmarks;

NOW, THEREFORE, BE IT ORDAINED BY THE CITY COUNCIL OF THE CITY OF HIGHLAND PARK, LAKE COUNTY, ILLINOIS:

SECTION ONE: That, pursuant to Section 24.025 of "The Highland Park Code of 1968", as amended, the following described properties be and the same are designated hereby as Landmarks:

Laurel Park	494 Laurel Avenue	16-23-413-018
Gardeners Memorial Park	1707 St. Johns Avenue	16-23-413-019

and as such shall be subject hereafter to the provisions of Chapter 24 of "The Highland Park Code of 1968", as amended.

SECTION TWO: That, as notice of the action of this City Council, the City Clerk shall forward certified copies hereof to those who nominated the aforescribed properties as Landmarks, to the owner of record of the aforementioned Landmarks, and to the Building Department of the City of Highland Park.

SECTION THREE; That this ordinance shall be in full force and effect from and after its passage, approval, and publication in the manner provided by law.

AYES: Mayor Pierce and Councilmen Blane, Brenner, Weiss, O'Keefe and Koukos

NAYS: None

ABSENT: Councilman Geraci

PASSED: May 26, 1992

APPROVED: May 26, 1992

PUBLISHED: June 4, 1992

ORDINANCE NO: 16-92

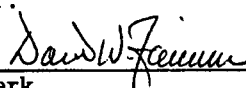

 Mayor

ATTEST:

 City Clerk

Regular Meeting - City Council

May 26, 1992

-7-

5. Mr. Bob Sanders, 1852 Park Avenue West, inquired about special assessments for storm sewer installation, storm sewer connection, and the culvert on Park Avenue West.

OMNIBUS VOTE

The Council unanimously consented to take a single vote by yeas and nays on several items grouped together for voting purposes under the designation "omnibus vote".

Councilman Weiss moved approval of Items 13, 14 and 15.

Councilman Koukos seconded the motion.

Upon roll call: Yeas: Mayor Pierce and Councilmen Blane, Brenner,
Weiss, O'Keefe and Koukos
Nays: None

The Mayor declared that the motion carried.

13. Ordinance - Designating Highland Park Landmarks

a. 892 Burton Avenue

Adoption of an Ordinance (No. 14-92), designating 892 Burton Avenue as a Highland Park Landmark.

Omnibus Vote

b. Rosewood Park

Adoption of an Ordinance (No. 15-92), designating Rosewood Park, located at the foot of Roger Williams Avenue at Lake Michigan, as a Highland Park Landmark.

Omnibus Vote

c. Laurel Park/Gardeners Memorial Park

Adoption of an Ordinance (No. 16-92), designating Laurel Park, 494 Laurel Avenue, and Gardeners Memorial Park, 1707 St. Johns Avenue, as Highland Park Landmarks.

Omnibus Vote

14. Ordinance - Establishing "W" Parking Permits

Adoption of an Ordinance (No. 17-92) entitled "AN ORDINANCE AMENDING THE TRAFFIC REGULATIONS OF "THE HIGHLAND PARK CODE OF 1968", AS AMENDED", providing for a "W" parking permit; and prohibiting parking at all times on the west side of Midlothian Avenue between Glenview and Onwentsia Avenues.

Omnibus Vote

Regular Meeting - City Council

May 26, 1992

-8-

15. Ordinance - Granting a Non-Exclusive Special License to Bojan's Auto Body of Highland Park, Inc.

Adoption of an Ordinance (No. 18-92) entitled "AN ORDINANCE GRANTING A NON-EXCLUSIVE SPECIAL LICENSE TO BOJAN'S AUTO BODY OF HIGHLAND PARK, INC. FOR THE PREMISES LOCATED AT 2058 FIRST STREET", permitting the awnings to encroach 2' over the public right-of-way at 2058 First Street.

Omnibus Vote

16. Release of Easements - Highland Lakes Subdivision

Councilman O'Keefe moved to table this Item to a future City Council Meeting.

Councilman Brenner seconded the motion.

Upon roll call: Yeas: Mayor Pierce and Councilmen Blane, Brenner,
Weiss, O'Keefe and Koukos

Nays: None

The Mayor declared that the motion carried.

OTHER BUSINESS FROM STAFF

There was no other business from staff this evening.

ADJOURNMENT

With no further business to conduct, Councilman Koukos moved to adjourn. The motion was seconded by Councilman Brenner and passed by acclamation. The Council adjourned its meeting at 10:25 p.m.

City Clerk

**Owner Consent Form
for
Highland Park Landmark Nomination**

Date: March 23, 1992

The undersigned owner of the property located at 494 Laurel Ave./1707 St. Johns Ave.
(Laurel Park & Gardener Memorial Park) (address), in the city of Highland Park,
Illinois, hereby

approves consent for the above property to be nominated by the Highland Park
Historic Preservation Commission for designation as a Highland Park Landmark

disapproves consent for the above property to be nominated by the Highland Park
Historic Preservation Commission for designation as a Highland Park Landmark.

(Please place an "X" in the appropriate space.)

Signature(s) Jerome C. Fell

Print Name(s) Jerome C. Fell

Address 636 Ridge Road, HP, IL

Phone # 831-3810



CITY OF HIGHLAND PARK

City Hall 1707 St. Johns Avenue
Highland Park, Illinois 60035
312/433-0600

March 25, 1992

Ms. Connie Skibbe
Director of Parks & Recreation
Park District of Highland Park
636 Ridge Road
Highland Park, IL 60035

Dear Connie:

This letter is to inform you that the Highland Park Historic Preservation Commission will hold a public hearing on Thursday, April 16, 1992, to make an official recommendation to the City Council that Laurel Park & Gardener Memorial be designated as a Highland Park Landmark. A public notice will be published in the Pioneer Press not more than 30 days nor less than 7 days prior to the hearing.

The meeting will commence at 7:30 PM. It is not required that you attend, but you are welcome if you so desire. Please call me if you have any questions.

The Historic Preservation Commission thanks you for your participation in the local landmarks program.

Sincerely,

A handwritten signature in black ink, appearing to read "Michael J. Kruse".

Michael J. Kruse
Director of Community Development

MJK:aaw

cc: Irv Wagner, Chairman Historic Preservation Commission

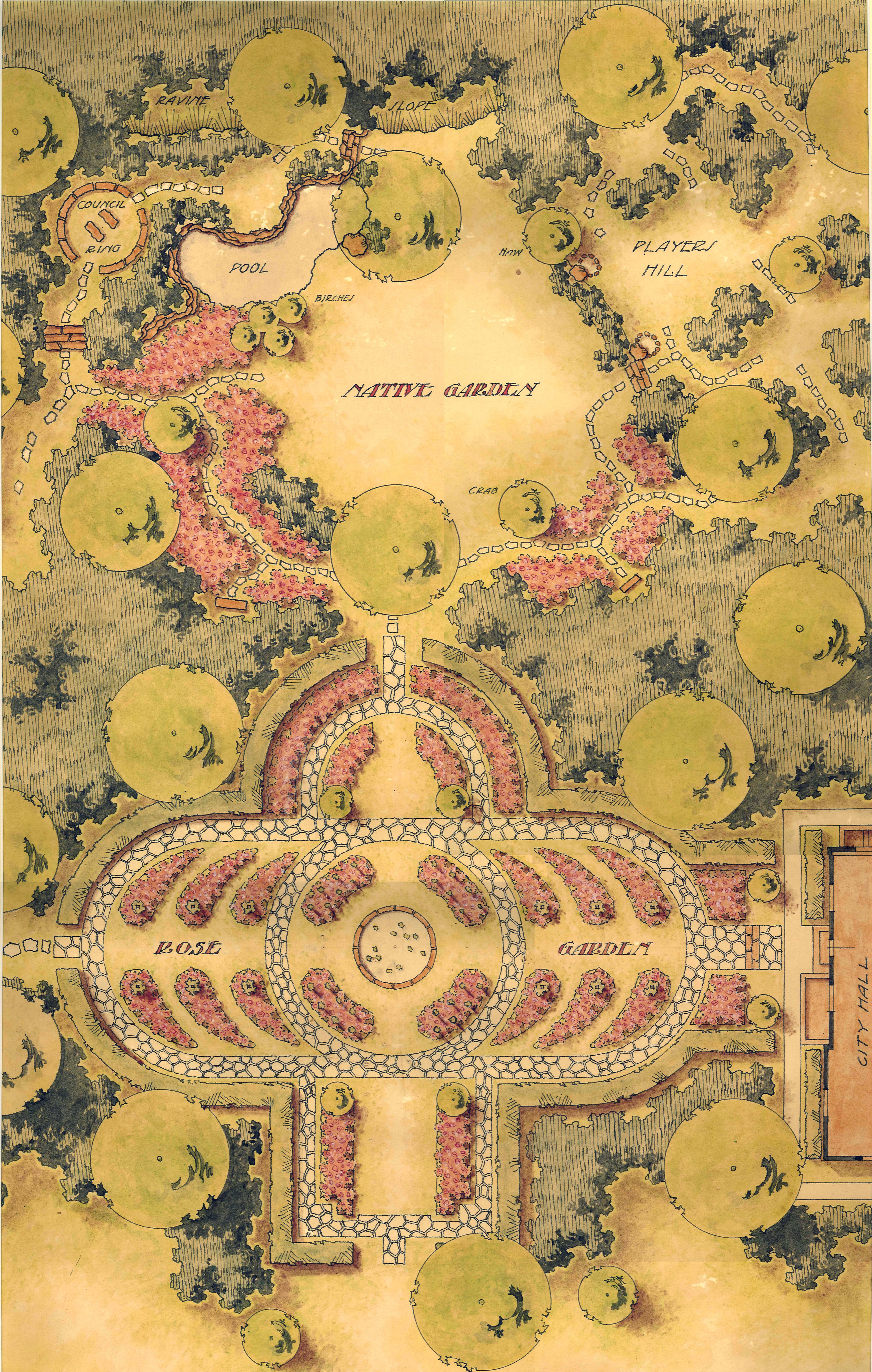

A MEMORIAL GARDEN

SPONSERED BY
 MEN'S GARDEN CLUB OF HIGHLAND PARK

CITY HALL PARK



SCALE 1/4" = 10 FT.

The Blackledge Group, Ltd.

LAND SURVEYING DIVISION

470 N. LIBERTY STREET - P.O. BOX 579

WAUCONDA, IL 60084 PH. 312/526-2823

PLAT OF SURVEY

ALL OF LOTS 23 AND 24 AND THE WESTERLY 70.00 FEET OF LOT 22 IN BLOCK 50 IN HIGHLAND PARK, A SUBDIVISION OF SECTIONS 23 AND 24 AND PART OF FRACTIONAL SECTION 14, TOWNSHIP 43 NORTH, RANGE 12 EAST OF THE THIRD PRINCIPAL MERIDIAN, (ACCORDING TO THE PLAT THEREOF RECORDED MAY 8, 1969, IN BOOK "A" OF PLATS, PAGE 2), INCLUDING THE SOUTHERLY HALF OF THE ALLEY ALONG THE NORTHERLY SIDE OF SAID PROPERTY, EXCEPTING THAT PART THEREOF DESCRIBED AS FOLLOWS:

BEGINNING AT THE SOUTHWEST CORNER OF SAID BLOCK 50, BEING THE SOUTHWEST CORNER OF SAID LOT 24, BEING ALSO THE NORTHEAST CORNER OF HAZEL AVENUE AND ST. JOHNS AVENUE; THENCE EASTERLY ALONG THE SOUTHERLY LINE OF LOTS 24, 23 AND 22, BEING THE NORTHERLY LINE OF HAZEL AVENUE, 223.50 FEET TO THE INTERSECTION WITH A LINE 70.00 FEET EASTERLY FROM AND PARALLEL WITH THE WESTERLY LINE OF SAID LOT 22; THENCE NORTHERLY ALONG SAID LINE, 70.00 FEET EASTERLY FROM AND PARALLEL WITH THE WESTERLY LINE OF SAID LOT 22, 205.67 FEET; THENCE SOUTHWESTERLY IN A STRAIGHT LINE, 281.82 FEET TO A POINT IN THE WESTERLY LINE OF SAID BLOCK, BEING ALSO THE WESTERLY LINE OF SAID LOT 24, BEING ALSO THE EASTERLY LINE OF ST. JOHNS AVENUE, 137.22 FEET NORTHERLY FROM SAID SOUTHWEST CORNER OF SAID LOT 24; THENCE SOUTHERLY ALONG SAID WEST LINE OF SAID LOT 24, 137.22 FEET TO THE PLACE OF BEGINNING, ALL IN THE CITY OF HIGHLAND PARK, LAKE COUNTY, ILLINOIS.

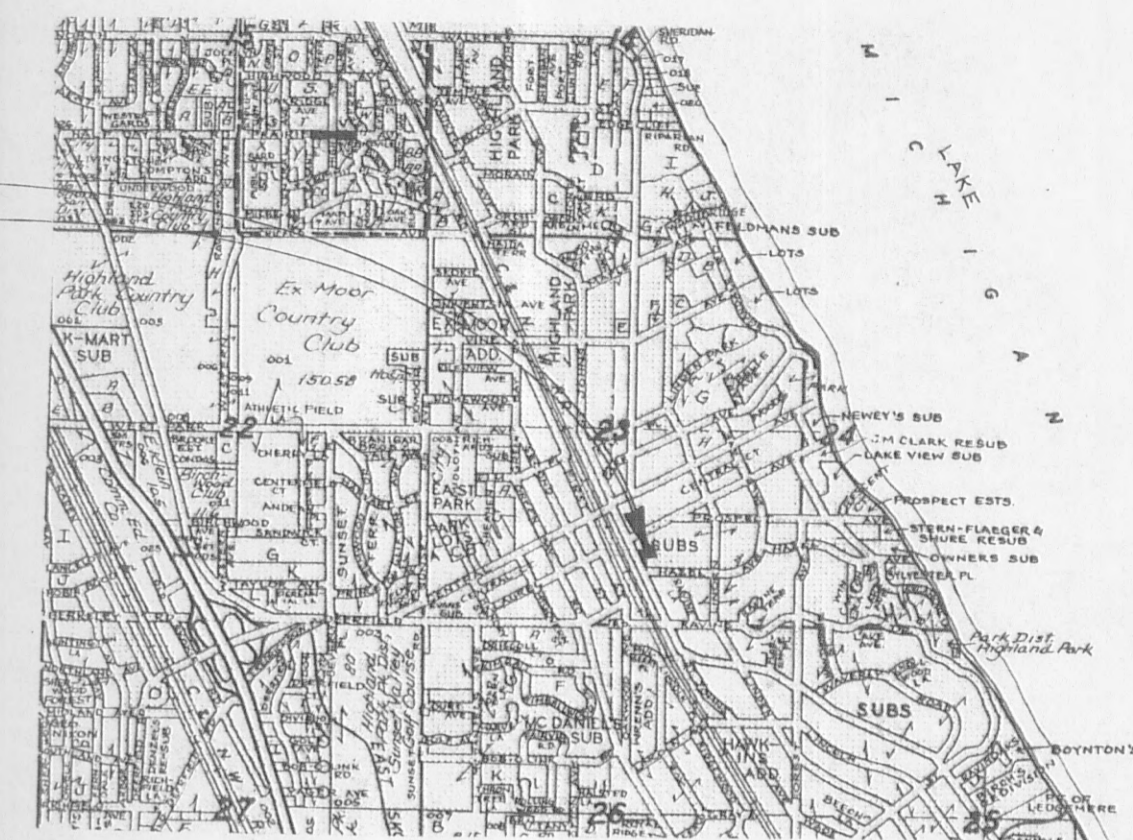

LOCATION SKETCH

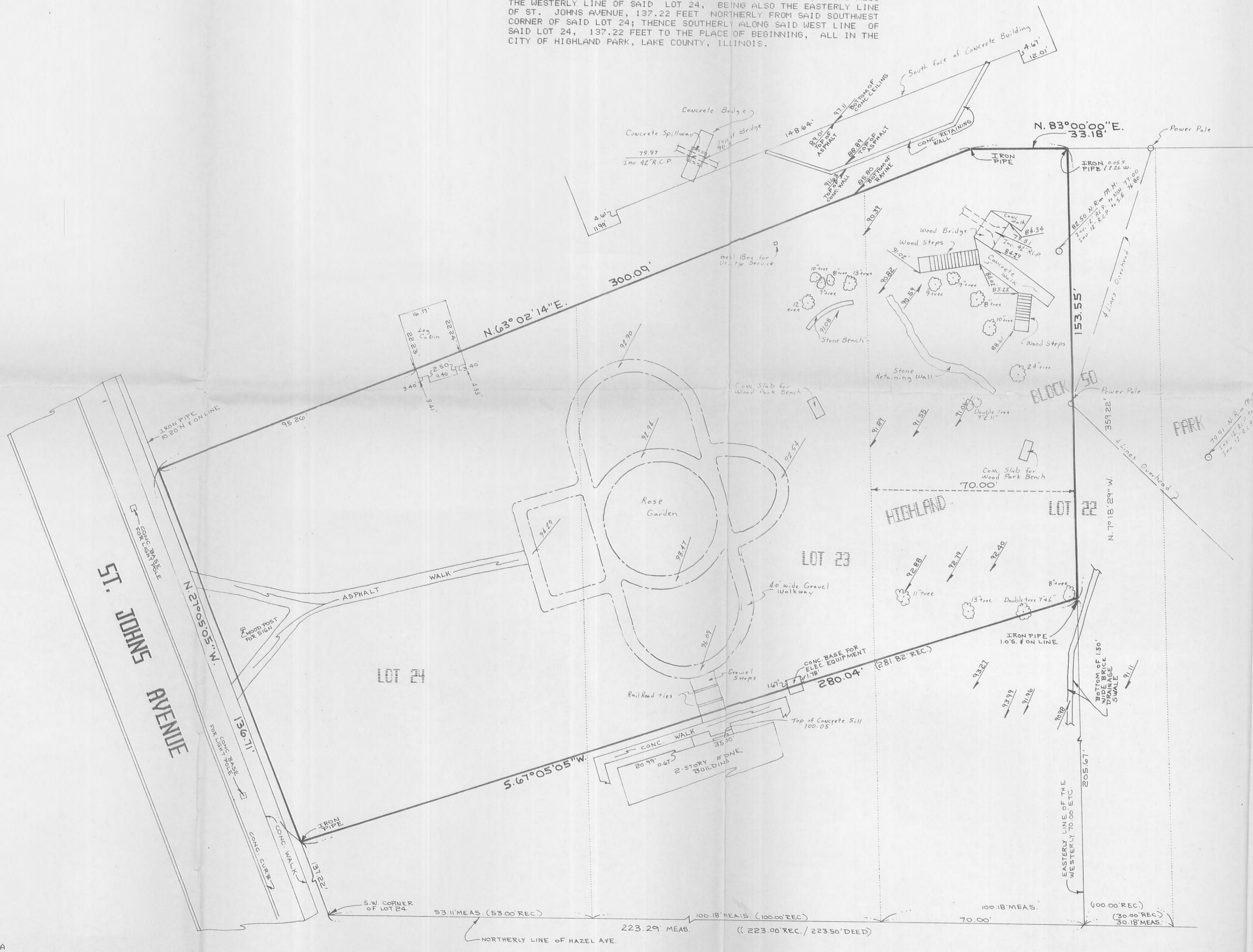

SURVEYORS NOTE:
THIS SURVEY SUBJECT TO REVIEW OF A
CURRENT TITLE POLICY FOR EXCEPTIONS
TO TITLE.

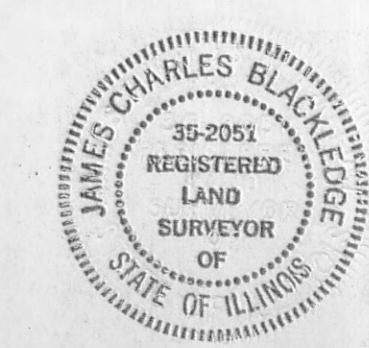

STATE OF ILLINOIS)
COUNTY OF LAKE) SS

TO: _____

WE, THE BLACKLEDGE GROUP LTD, DO HEREBY CERTIFY THAT WE HAVE SURVEYED THE ABOVE DESCRIBED PROPERTY AND THAT THE PLAT HEREON DRAWN IS A CORRECT REPRESENTATION OF SAID SURVEY, CORRECTED TO A TEMPERATURE OF 68° FAHRENHEIT.

James C. Blackledge
J.C.R.L.S. NO. 2051

CUSTOMER: HIGHLAND PARK - PARK DISTRICT
SCALE: 1 INCH = 20 FEET DRAWN BY: JCS
DATE: 1-21-86 CHECKED BY: JCS

ADDENDA	ORDER	DESC.

SURVEY NO. 86-0031

DISTANCES ARE MARKED IN FEET AND DECIMAL PARTS THEREOF. COMPARE ALL POINTS BEFORE BUILDING BY SAME AND AT ONCE REPORT ANY DIFFERENCE. REFER TO ABSTRACT, DEED AND LOCAL ORDINANCES FOR BUILDING RESTRICTIONS. ALL CERTIFIED PRINTS OF THIS SURVEY BEAR AN IMPRESSED SEAL.

For a short period, in 1934-35 Jensen and Johnson became partners. When Jensen retired to the Clearing in Door County, Wisconsin in 1935, Marshall Johnson established his own practice. He used the hawthorn tree logo, and continued to work for many of Jensen's private clients including the Fords in Michigan and the Florsheims in Highland Park.

Johnson's designs combined Jensen's Prairie style with the more traditional and formal design elements. In addition, he successfully adapted the designs to the smaller lot sizes and modern needs of his clients. He continued his practice into the late 1960's.

Women's Club, L-1991 Sheridan Rd., D- 1936, A- , LA- Fritz Bahr/ Marshall Johnson, Des - no

According to Highland Park By Foot or Frame the Women's Club landscape was designed by Fritz Bahr in 1936. However, there is an original plan dated 1937 by Marshall Johnson for this property. The siting of the building is consistent with the Johnson drawing. The present plantings give no indication whether or not Johnson's plan was executed.

Laurel Park/ Gardener's Memorial L- St. Johns Avenue between Hazel Ave. and Laurel Ave., D- 1942, A-, LA- Marshall Johnson, Des- NR District, LL

Laurel Park/ Gardener's Memorial was designed by Marshall Johnson for the Men's Garden Club of Highland Park to commemorate three highly regarded local naturalists: William C. Egan, Jesse Lowe Smith, and Jens Jensen. This landscape is an example of Johnson's ability to incorporate formal and naturalistic styles successfully into a unified design plan. When the Park was finished and dedicated in 1942, Jensen came back to Highland Park from "The Clearing" to attend the ceremony.

The formal section of the Park is the rose garden, which was a collaboration between Johnson and Eugene Pfister, president of the Men's Garden Club. This section was created in honor of William C. Egan because he was the first rosarian in the area (see pp. 16 and 21). A wildflower garden at the northeastern third of the Park was meant to honor Jessie Lowe Smith, naturalist and local educator who fostered a love for nature in his students (see p. 21). Players Hill, an area at the southeastern section of the Park is a reminder of Jens Jensen and his many contributions to Highland Park.

Currently plans are being developed by the Park District and the Historic Preservation Commission to restore Laurel Park/ Gardener's Memorial. The original configuration and shape of the rose beds are almost

exactly intact. Many of the original roses planted in the garden did not adapt well to the climate and through the years they have been replaced with alternate varieties. Clayton Sandel, an early member of the Men's Garden Club is currently evaluating the roses to determine the best possible cultivars which combine hardiness and original design intent. The Rose Garden once had a round pool in the center which is now filled and planted with flowers, but will be reinstated to its original use.

The tall hedge buckthorn enclosing the Rose Garden is now sparse and shabby in appearance. When the garden was planned that cultivar was new and popularly received. Since then it has been found to have many disease problems which ruin its appearance and shorten its life. A search is now being made to find a similar but healthier plant.

The two natural sections, the Native Wildflower Garden and Players Hill are more difficult to evaluate and research is still being conducted. The sundial bench and the rocky ledge pool in the Wildflower Garden are intact, though the pool has been filled in. The sundial is actually not included in the original plan. It appears that it was used as an alternative to a council ring which was included at approximately the same location on the plan.

Koretz House, L-2365 Egandale Rd., D- 1948, A-, LA- Marshall Johnson, Des-
no

This small residential landscape is still owned by Johnson's original client, Mr. Robert Koretz. A copy of the original Johnson plan for this property was made available for the survey. The original plan primarily reflects the Prairie style, but the landscape has undergone some changes over the years. Today it is an eclectic statement, combining the Prairie style with English features.

Originally, the property had a curving stone path leading to the front door and a stonework area beneath the front portico. The front entranceway was changed in 1956. At this time, the stone path was replaced with a brick path, and the stonework portico area was removed. An English style country dooryard perennial garden was also added in front of the house at that time. An original brick path leads to one side of the house and widens as it nears the backyard. This stonework is well intact. The backyard is similar to the original plan only in feeling. It still appears to be a carved out space. However, most of the plant materials specified in the original plan no longer exist except for sumac, some viburnum and crab. The council ring campfire which was previously at the rear of the backyard has also been removed. Some of the other original stone paths at the back of the house also still exist.

Herman Wren House, C- Seven Gables, L- 2020 Partridge Lane, A- Robert
Arnold, LA- Marshall Johnson, D- 1963, Des- no

This property illustrates the point that Johnson was far more pragmatic, and willing to incorporate formal design into his overall plans than Jensen. In addition, it might be speculated that Johnson was more willing to deviate



St Johns Ave

1700

1755

1707

493



Planning for a Permanent Place of Remembrance: Communications Plan

April 3, 2024

Values

The following are the City of Highland Park Community Values as the City prepares for a place of remembrance following the shooting that took place on July 4, 2022. The working group's approach will be trauma-informed, and meetings and discussion should serve as a safe space for ongoing discussions.

Community Values

Inclusion

Transparency

Respect and value all opinions

The outcome will last for decades into the future

Purpose

A communications plan includes **objectives** that align with the overall project, identifies key **stakeholders** and **communications channels**, sets **timelines** and **allocates resources**, outlines **strategies** to address potential communication risks, and includes ongoing **evaluation** to ensure objectives are being met.

The process of planning for a place of remembrance is just beginning. This presentation focuses on:

- Objectives
- Stakeholders
- Channels
- General Timelines

Guiding Principles for Communications

- **Do No Harm:** consider as carefully and as thoroughly as possible the potential and inadvertent consequences of the words and images we use
- **Opt-In:** as much as possible, give individuals the opportunity to decide how and when to engage with content
- **Trauma-Informed:** work to avoid re-traumatization by using victim-centered language, being cognizant of the potential for inadvertent harm, and practicing transparency and open communication
- **Individualized:** consider many experiences of trauma, including within stakeholder groups, when planning the frequency and modality of communications

Objectives

1. Keep the community informed of the activities of the working group and milestones in the planning process.
2. Tailor messaging to the needs of each stakeholder group.
3. Maintain two-way communication and facilitate community engagement.
4. Ensure transparency by promoting meetings and providing resources and documents related to the planning process.
5. Enhance accessibility by providing materials in multiple languages and formats to meet the diverse communication needs of individuals impacted by the shooting.

Objective 1: Keep the Community Informed

The City uses **multiple communications platforms** to share information regarding the planning process:

- Website: hpremembrance.org
- Facebook: facebook.com/HighlandParkIL
- Weekly eNews: cityhpil.com/signup
- Dedicated email list: email remembrance@cityhpil.com to sign up
- The Highlander: bimonthly print newsletter

Objective 1: Keep the Community Informed

Additional communications modalities:

- Public meetings
 - Working group meetings open to the public
 - Updates at City Council meetings
 - Neighborhood meetings
 - Forthcoming community engagement meetings
- Partner organizations
 - Resource partners
 - Government partners
 - Business community
 - Clergy
- Media outreach

Objective #2: Tailor Messaging to Stakeholders

- Identify **core messages and adapt delivery** based on the needs of different stakeholder groups:
 - Next-of-kin Family Members
 - Individuals Present & Injured
 - Individuals Present & Uninjured
 - Highland Park Community
 - Community Beyond Highland Park
 - Government/Resource Partners & Clergy
- **Establish a cadence** to set consistent expectations for the frequency, volume, and type of communication
- Create an archive of communications so that community members can **opt in or out** without fear of missing important information

Objective #3: Facilitate Community Engagement

- Work with a **professional consultant** to design, manage and analyze community feedback in a trauma-informed manner
- Provide **multiple ways to share feedback**
- Offer **structured and unstructured** opportunities for feedback

Objective #4: Ensure Transparency

- Promote **public meetings** of the working group
- Provide periodic **public updates** from the working group at City Council meetings and in City communications
- Maintain an **archive of meeting notes, documents and presentations** at hpremembrance.org so that people who are unable to attend meetings can still participate

Objective #5: Enhance Accessibility

- Enhance **language accessibility** by:
 - Using an embedded website translation tool
 - Providing materials in Spanish, Russian, and other languages as requested
 - Offering simultaneous interpretation (including ASL) for events
- Enhance **website accessibility** by:
 - Optimizing website design for assistive technology
- **Remove barriers to participation** in engagement activities by:
 - Offering opportunities to connect or share feedback through a variety of different modalities
 - Working with resource partners to meet people where they are
- **Apply trauma-informed principles** by:
 - Making people aware of when to expect communications
 - Ensuring communications are always available for reference
 - Providing advance notice of potentially re-traumatizing topics
 - Collaborating with community partners so they are aware of the communications plan and able to assist clients
 - Including reminders of Resiliency Division services

Setting Expectations: Type & Frequency

What to Expect	How Often
Meeting Notices (eNews, FB, website, email)	Week prior to meeting
Meeting Summary (eNews, website, email)	eNews immediately following most recent meeting
Bimonthly Update (Highlander)	Each issue
Focus group or other event (eNews, FB, website, email)	Week prior to event
Community surveys (eNews, FB, website, email)	Announcement, periodic reminders during survey period, reminder before close)

Note:
Information will be archived at hpremembrance.org

Individuals may opt-out (or opt back in) at any time

Setting Expectations: Use of Images & Graphics

What image or graphic?	Where is it used?
Together Highland Park Unidos Logo	Social media, email blasts, signage, website, print
Photos of the temporary memorial	Website, social media (for social media, only the two entrance plaques)
Photos of victims	Temporary memorial only
Generic “stock” photos: City Hall, lakefront, candles, etc.	Social media, occasionally print
FUTURE: design renderings, prototypes, maquettes	Website, social media, print, email blasts, signage (at events)

Note:
The City is intentional about the use of imagery or graphics. These are the only types of images you can expect the City to use in relation to planning for a permanent place of remembrance.

Contact Information

Feedback regarding communications:

Ghida S. Neukirch

City Manager

gneukirch@cityhpil.com

Amanda Bennett

Communications Manager

abennett@cityhpil.com

Information regarding the Resiliency Division:

Emily Taub

Assistant City Manager

etaub@cityhpil.com

Madeline Kati, LCSW

Resiliency Manager

mkati@cityhpil.com



Questions?

Highland Park

Place of Remembrance

Phase 1 | Public Engagement Summary

May 7, 2026

Table of Contents

Introduction	<i>3</i>
Overarching Themes	<i>7</i>
Site-Specific Themes	<i>14</i>
Design Character Preferences	<i>19</i>
In Closing	<i>35</i>

Introduction

The City of Highland Park, in partnership with [SWA Group](#) and [All Together](#), is undertaking a trauma-informed process to create a permanent place of remembrance to pay tribute to the memory of the seven victims of the Highland Park shooting, create space(s) for reflection and remembrance, and honor the community's resiliency, especially those who were injured. This process entails multiple phases described in detail at hpremembrance.org/timeline.

This report, prepared by All Together, synthesizes all community input gathered during Phase 1: Design Ideation of the Highland Park Place of Remembrance design process. This included a multi-tiered survey, individual and group listening sessions, and a community workshop, all conducted between February and April 2026.

Feedback gathered throughout Phase 1 will inform high-level design features and the overall feel of the permanent Place of Remembrance, providing the foundation for concept designs developed in Phase 2: Design Concepts, which will include additional opportunities for community engagement.

Our Design Ideation Timeline

Phase 1 builds on a prior location study, with Do Tank, which concluded in January 2025 with a recommendation for a two-site approach: a prominent primary Place of Remembrance at the Rose Garden and a subtle, secondary Place of Remembrance at Port Clinton. The City Council supported the recommendation in April 2025. This first round of engagement gave the design team, SWA Group and All Together, the opportunity to learn about victims and their loved ones, understand which design elements matter most, and gather open-ended input to inform early concept development.

Multi-Tiered Engagement

This engagement process started with those most closely connected and expanded out to the entire Highland Park community and our neighbors. Every voice we heard was valuable in shaping this summary of engagement and furthering design concepts. For this document, references to each tier include but are not limited to the following:

Tier 1

Next of kin, present and injured, first responders (Police, Fire, EMS, and others who provided direct on-scene care and response), and healthcare workers

Tier 2

Present not injured, parade participants, community leadership, resource partners, businesses, volunteers, first responders, donors, and others who provided support as part of the initial response and emergency management efforts, and those who live and work in proximity to either site

Tier 3

Community members and organizations at large

How We Engaged

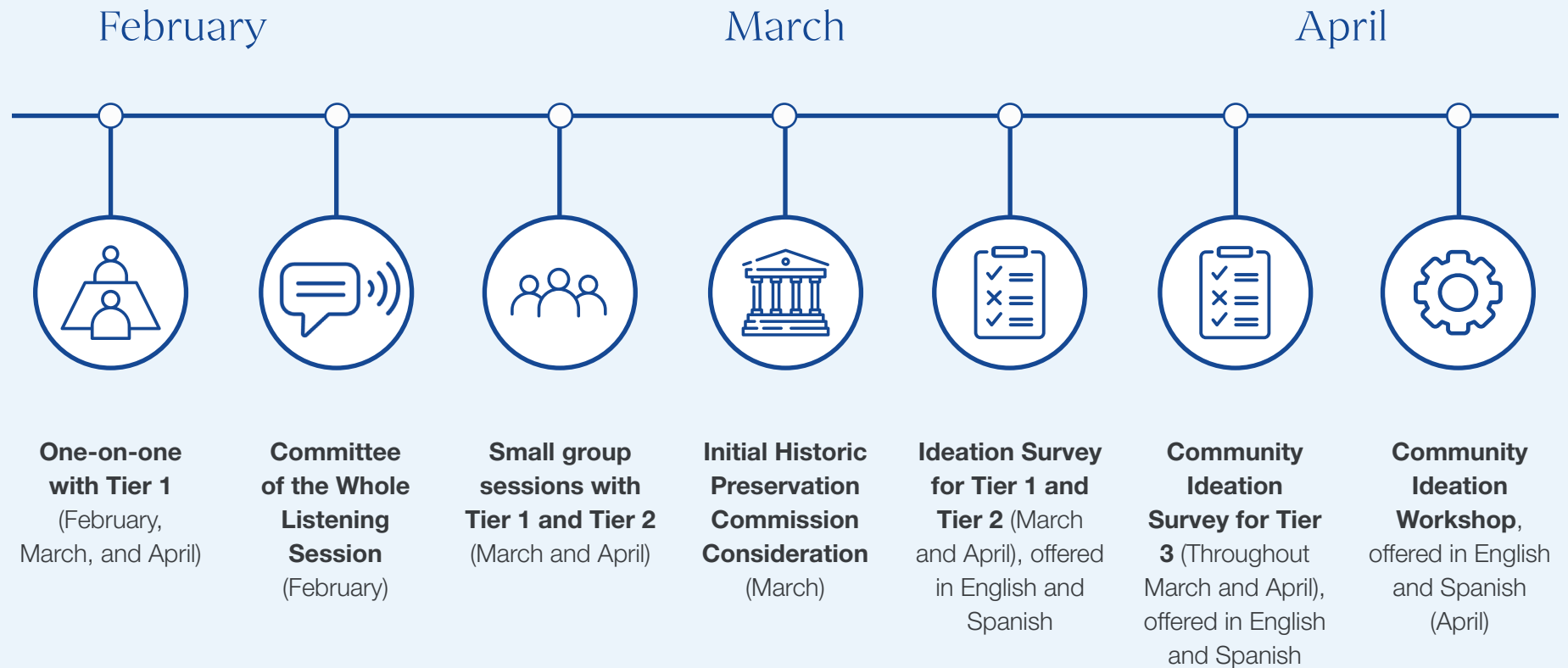

Communications Strategy

The Phase 1 communications plan included differentiated outreach to each tier, including email, telephone, and written outreach as appropriate to the needs of each tier. Updates and promotions were included in the Highlander, the City eNews, and social media, and were co-promoted by government and community partners, including a live video interview on the Highland Park Public Library’s Caminando Juntos livestream. The Resiliency Division also offered direct engagement through tabling events at the Highland Park Public Library and personal outreach to Tier 1.

Who We Heard From

Phase 1 engagement resulted in **179** voices: **124** survey respondents and **55** additional participants across listening sessions and the workshop.



Overarching Themes

Across all engagement formats (surveys, individual listening sessions, group listening sessions, and the community workshop), six themes emerged with the greatest consistency. These are the threads that ran through nearly every conversation.

Name the seven whose lives were taken. Acknowledge all who were harmed.

The most universally held position across all engagement: names of those whose lives were taken should appear in the design, given prominence, and clearly acknowledged.

Names of the seven whose lives were taken were a consistent and emotionally significant request from Tier 1 voices, particularly from those who survived with injuries.

“How can the individuality of each person who died come across in the design, in a way that is intimate without being overt?”

Tier 1 Listening Session Participant

Additional feedback suggested including the 48 individuals who were physically injured and acknowledgment to the broader population whose lives were changed without

visible wounds; both should be reflected in the space in some form. Many stakeholders indicated this should be done discreetly, without naming, but still meaningfully. Language acknowledging being ‘forever changed’ was suggested.

Honor the people and communities that showed up.

Participants across all groups described a community that sheltered and cared for people who were injured, organized mutual aid, and came together to provide support. That story of ordinary people doing extraordinary things was named as something the design should carry forward.

“So many heroes and people, you can’t even account for all of the heroic actions. The community cares and showed up, and there’s a lot that future generations can take from that.”

Tier 2 Listening Session Participant

“Heroism” across first responders, healthcare workers, institutions, and communities was specifically named as something that should be reflected in the design. Mutual aid from surrounding communities was specifically raised as something worth acknowledging beyond Highland Park alone. The design offers an opportunity to honor that broader community of care.

Tell the story of the full community, not only what happened.

When participants were asked what they hoped future generations would understand when visiting the Place of Remembrance, their answers were consistent: that Highland Park is a community that cares deeply for one another. Several participants framed resilience as a statement around community and relationships. The parade has always been a multi-generational event that, for decades, brought the entire community (and surrounding areas) together. Families, friends, and neighbors chose to care for one another throughout the event and long after. The shooting does not define who this community is, but how people showed up for each other in its wake does. The design and the stories it tells should hold both what was taken and what this community proved itself to be.

“A story of a community that remembers with care, stands together in the face of loss, and balances grief with everyday life.”

Tier 1 Survey Respondent

Design for remembrance in every season.

Year-round vitality was the most consistent design request across all formats and groups. Participants did not want a space that looks grey and barren for six months of the year. They described a place that holds up in winter through evergreen plantings, materials that age with dignity, and design that does not rely solely on flowers or foliage to carry meaning.

In many sessions, participants described that the seasonality of the Place of Remembrance could reflect the process of grief, life, and new beginnings. Native plants that thrive in Chicago conditions were specifically preferred. Several participants also raised the symbolic dimension of seasonality: spring as renewal, winter as quiet persistence. The design should hold meaning year-round, not only in bloom.

*“Pretty and well-taken care
of regardless of the season.
This is especially tough
during winter.”*

Tier 1 Survey Respondent

Hold space for cultural diversity with intention.

The majority of those whose lives were taken were Latino and/or Jewish. Multiple participants asked that the design honor those specific communities, not as an afterthought but as a core design responsibility.

Participants offered concrete, specific ideas: marigolds and Mexican sunflowers as culturally significant plants; butterflies and hummingbirds as symbols of transformation; a place for pilgrimage as is Jewish tradition, and a place for a celebration of life after death as is the Latino/Christian tradition, and that the Spanish language be included in any physical signage or inscriptions that may be incorporated into the design.

“Butterflies and hummingbirds are important for the Latino community. They symbolize transformation – a visit of the soul from a loved one.”

Tier 2 Workshop Participant

Several participants named the risk of design that gestures broadly toward the community without honoring anyone in particular. The request was to be specific: to name the communities, to include their symbols, to design with enough cultural knowledge that the references are legible to those for whom they carry meaning, and discoverable for those who want to learn more.

Let people choose when, and whether, to engage.

Participants expressed a consistent and deeply felt need: the ability to choose when, how, and whether to engage with the Place of Remembrance. This came from many directions and people with varied experiences. Some are grieving and want to intentionally seek out the space. Others need to be able to move through downtown Highland Park, go to work, bring their kids to events at Port Clinton, or simply have lunch without being pulled into a somber experience they are not ready for. First responders and other city staff who worked the day of the shooting, throughout the investigation, and

continuing to the present, described the emotional weight of regular proximity to reminders of the event.

} *“Some people will come to grieve, some to remember, some simply to sit. The space should hold all of that without telling anyone how to feel.”*

Tier 3 Survey Respondent

Community members who

live and work near both sites asked that the design not make grief unavoidable. The same request came from those who spend time near both sites in their daily lives: the design should allow people to step in when they choose to, and step past when they need to. This principle has implications for both sites and for the connection between them. At the Rose Garden, it means clear entry and exit points, a space that holds meaning without imposing it on those working or walking nearby. At Port Clinton, it means a presence that is intentional, that celebrates this community while acknowledging what happened and creating conditions where people retain agency over their own experience.



Site-Specific Themes

Across all engagement formats (surveys, individual listening sessions, group listening sessions, and the community workshop), participants found common ground around how they'd like each site to feel.

The Rose Garden

The Rose Garden carries the broadest support as the primary, dedicated site for remembrance. Agreement on this designation holds across all tiers of engagement and is consistent with Do Tank's findings in 2025.

What the Space Should Include

- Acknowledgment of the seven lives taken and those injured
- Comfortable seating, including benches with backs, shaded, and designed to invite reflection
- Living plantings with year-round color
- A water feature for emotional regulation and sensory engagement (note: Participants noted that design constraints around maintenance and cost should be considered)
- Clear sightlines throughout, because visibility supports safety and agency for trauma survivors
- Multiple entry/exit points, including preserved access from the City Hall rear parking lot
- Design elements that honor the site's existing history as a landmark
- Full ADA accessibility, including smooth, even pathways; no gravel; and snow- and salt-clearable
- Cultural sensitivity with elements that honor Jewish and Latino traditions
- Sensory elements that ground you in the space through color, texture, and sound are woven throughout
- Intentional plant selection where species names and symbolism are considered
- Presence beyond the garden's edge, including subtle connections to the roadway so the space isn't hidden or invisible to passersby
- Meaning to future generations who were not present

What The Rose Garden Should Feel Like

Contemplative

Natural

Peaceful

Private

Reflective

Serene



Port Clinton Plaza

Port Clinton Plaza is the heart of downtown and the site of the shooting. It serves as an actively used public space in Highland Park, hosting 20–25 events, businesses, and numerous other activations each year. This subtle, secondary site for the Place of Remembrance will give us an opportunity to acknowledge the lives taken and resilience of the community while also being respectful of this premiere destination, place of business, primary residence, and public space.

What the Space Should Include

- Acknowledgment that the shooting happened here, honoring the lives taken while also affirming the lives that continue
- Elements that foster its continued function as downtown’s heart, and a multi-functional space that welcomes everyday life, businesses, and special events
- Plants and natural elements to soften the brick-heavy plaza, signaling care without requiring engagement with the memorial
- Symbolism honoring the seven victims whose lives were taken through plantings or other design elements
- Structurally significant enough that people don’t walk or play on it, but that it doesn’t distract from the everyday experience at Port Clinton

What Port Clinton Should Feel Like

Everyday

Dynamic

Layered

Vibrant

Resilient

Welcoming

Connections between the Sites

Most participants expressed that the two sites should feel related without being literally linked. A physical path or breadcrumb trail between them was specifically flagged as inappropriate. Instead, participants described something quieter: a shared element that speaks between the sites without announcing itself. A symbolic or visual echo was the most consistent request, with participants suggesting shared color, plant species, artwork, or material that appears at both sites and carries meaning without explanation.



Design Character Preferences

During Phase 1: Design Ideation, participants engaged with mood boards that included representative images of different design elements and aesthetic directions that could be incorporated into the Place of Remembrance at the Rose Garden or Port Clinton. Images were grouped to represent these different directions, and participants shared where their preferences fell along the spectrum. This feedback helped the design team to identify areas of consensus and where opinions varied.

Community Ideation Results

<i>Dimension</i>	<i>Options</i>	<i>Tier 1 Survey Avg (Scale: 1-3)</i>	<i>Tier 2-3 Survey Avg (Scale: 1-3)</i>	<i>Workshop / Listening Sessions</i>	<i>Sum of Preference</i>
Movement	1. Informal: Loose, Open, Naturalistic 2. Semi-Formal: Curvilinear, Organic, Flowing 3. Formal: Linear, Direct, Hard	1.85	1.83	Preference for option 2	Semi-formal; curvilinear; meditative flow
Material	1. Soft, Loose, Natural, Dynamic, Atmospheric 2. Defined but Natural, Rough Edges 3. Hard, Clean, Crisp, Clear	1.82	1.77	Preference for options 1 and 2	Natural, accessible; no gravel

Community Ideation Results

<i>Dimension</i>	<i>Options</i>	<i>Tier 1 Survey Avg (Scale: 1-3)</i>	<i>Tier 2-3 Survey Avg (Scale: 1-3)</i>	<i>Workshop / Listening Sessions</i>	<i>Sum of Preference</i>
Color	1. Naturalistic, Softer, Earthier 2. Quiet, Cool, Relaxed 3. Bright, Cheerful, Exuberant	1.96	1.92	Preference for options 2 and 3	Midpoint; outlier tension
Night Presence	1. Soft Accents, Atmospheric, Ambient 2. Defined, Strong, Bold 3. Dynamic, Sculptural	1.70	1.68	Preference for option 1 at Rose Garden and option 3 at Port Clinton	Quiet at Rose Garden; expressive at Port Clinton

Community Ideation Results

<i>Dimension</i>	<i>Options</i>	<i>Tier 1 Survey Avg (Scale: 1-3)</i>	<i>Tier 2-3 Survey Avg (Scale: 1-3)</i>	<i>Workshop / Listening Sessions</i>	<i>Sum of Preference</i>
Nature	1. Ecological, Dynamic, Informal 2. Curated but Dynamic, Naturalistic, Sculptural 3. Formal, Architectural, Familiar	2.12	2.06	Preference for option 2	Curated/naturalistic — strongest consensus
Memory	1. Simple, Minimal, Reserved 2. Narrative Driven, Informative 3. Abstract, Representative	1.81	1.75	Preference for options 1 and 2	Simple to narrative; keep the '7'

Movement Directions

OPTION 1



OPTION 2

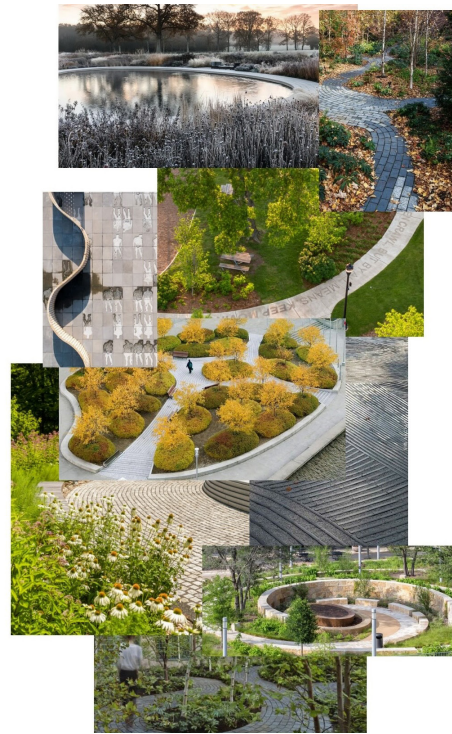

OPTION 3

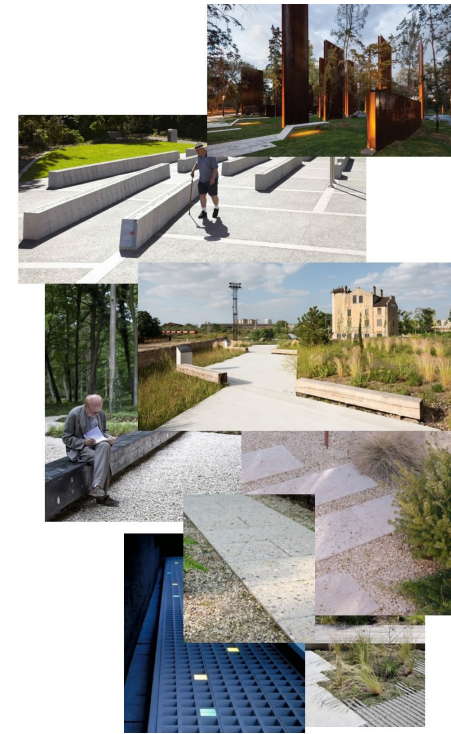

1

Informal

Semi-Formal

Formal

3

DIMENSION 1 OF 6

Movement

TIER 1



1.85

TIER 2-3



1.83

1— Informal

2— Semi-Formal

3— Formal

WORKSHOP / SESSION PREFERENCE

Option 1

Option 2

Option 3

Key Takeaways

- Curved paths, spirals, and a more flowing layout
- The act of walking as meditative, including movement and paths that take you somewhere without feeling rushed or directed
- Plantings that move a visitor through the sense of place, using the landscape itself as a guide
- No large solid walls to avoid feeling “boxed in” but easy to find a private space as you move through
- Railings for those who need support, smooth walkways for those with walkers or canes, lighting for the days when it gets dark early

I like the idea of mindfulness in this space. Walking along rocks, feeling that sensory moment, and using that as a way to meditate/process privately.

Tier 1 Listening Session Participant

Material Directions

OPTION 1



OPTION 2



OPTION 3

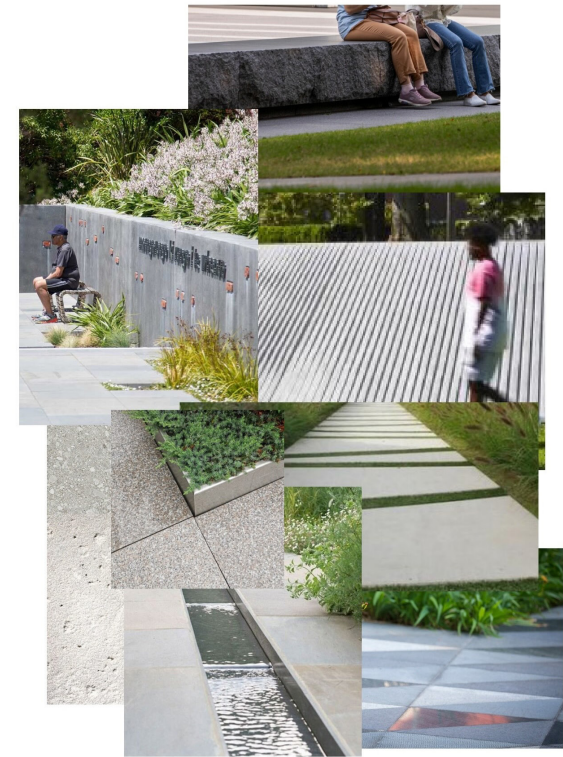

1

Soft/Natural

Defined

Hard/Crisp

3

DIMENSION 2 OF 6

Material

TIER 1



1.82

TIER 2-3



1.77

1- Soft/Natural

2- Defined

3- Hard/Crisp

WORKSHOP / SESSION PREFERENCE

Option 1

Option 2

Option 3

Key Takeaways

- Natural materials overall, including wood, textured stone, and organic forms
- Elements that age gracefully and signal care
- Accessibility as the primary driver when considering material, which should include non-slip surfaces, clear-able from snow and salt, wheelchair- and walker-compatible
- Regional materials, including stone native to this geography
- Material choices that don't create climbable elements
- Seasonal plant material

When you think of material, accessibility is the first thing that comes to my mind. Whatever direction we go with this – ADA friendly and inviting.

Tier 1 Listening Session Participant

Color Directions

OPTION 1



OPTION 2



OPTION 3



1

Earthy

Quiet/Cool

Bright

3

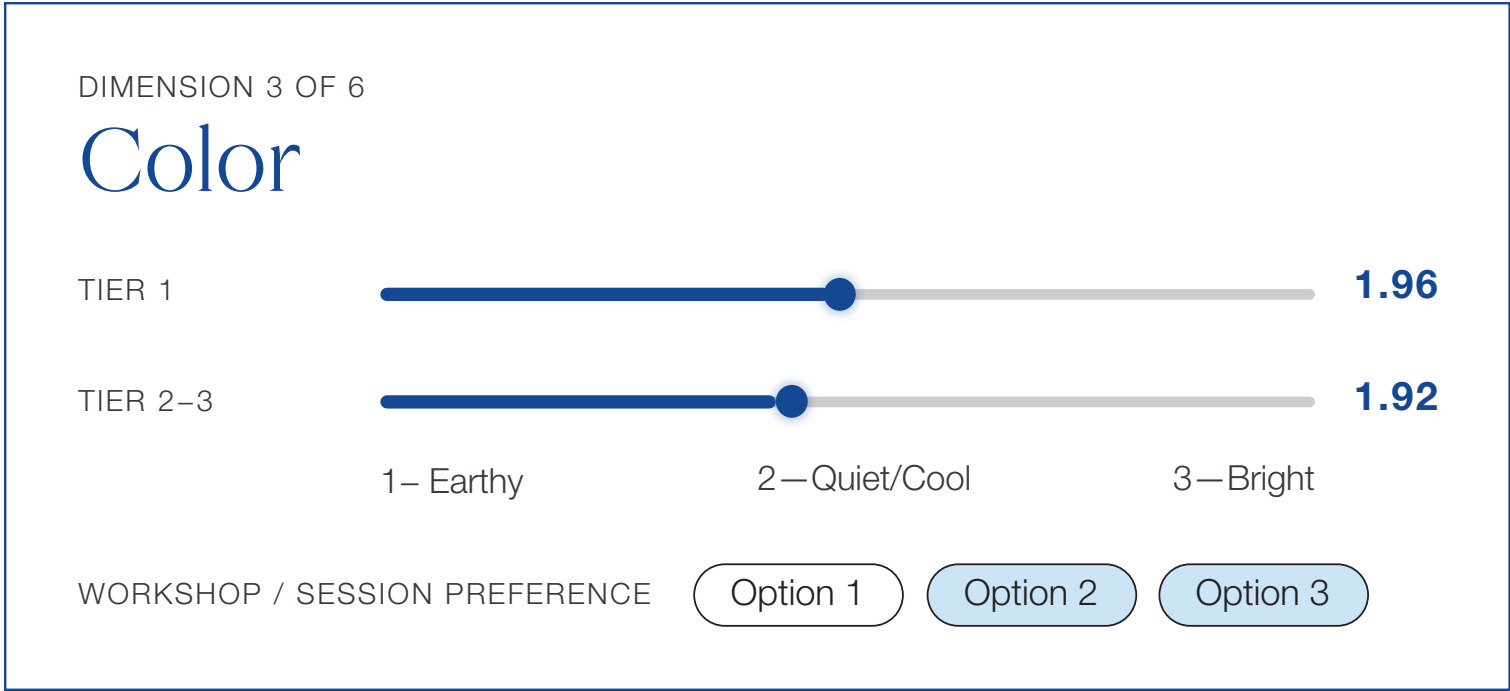

Key Takeaways

- Some participants expressed a preference for a quieter, ecological palette, including pale pinks, purples, whites, and natural tones
- Some participants expressed a preference for vibrant, culturally-specific color incorporated through plantings of meaningful varieties such as marigolds and Mexican sunflowers
- A naturalistic palette can include vibrant colors through living material that reads as quiet from a distance and specific up close
- Kaleidoscope/reflected light as a way to introduce color through material and light
- Color infused through non-plant materials as an alternative to plant color alone
- Seasonality is considered, so color is present even when plants are dormant

Despite what happened, this community has so much joy. I think colors are beautiful and important. They bring us natural joy.

Tier 1 Listening Session Participant

Night Presence Directions

OPTION 1

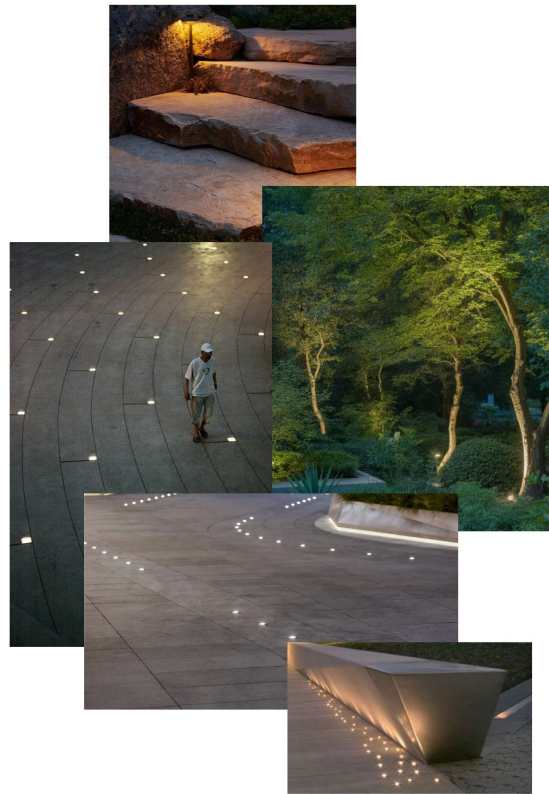

OPTION 2



OPTION 3



1

Soft/Ambient

Bold

Dynamic/Sculptural

3

DIMENSION 4 OF 6

Night Presence

TIER 1



1.70

TIER 2-3



1.68

1— Soft/Ambient

2— Bold

3— Dynamic/Sculptural

WORKSHOP / SESSION PREFERENCE

Rose Garden

Option 1

Option 2

Option 3

Port Clinton Plaza

Option 1

Option 2

Option 3

Key Takeaways

- Light that feels intentional and used for accessibility and safety
- (Rose Garden at night): Softer, more atmospheric accents. Concerns about dark-sky compliance were raised because the space is near the ravine ecosystem and visible from residential properties
- (Port Clinton at night): Expressive and experiential use of light that is interactive, kid-friendly and engaging

Light could be used not only as an accent, but as part of the memorial.

Tier 1 Survey Respondent

Nature Directions

OPTION 1



OPTION 2

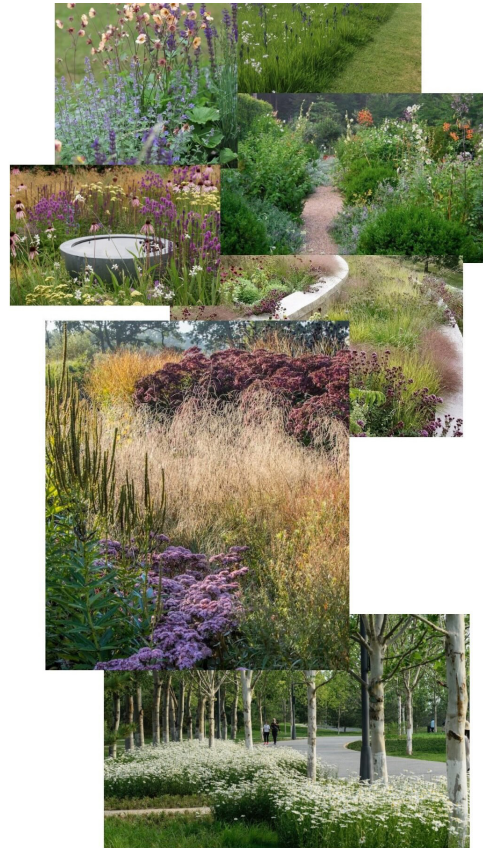

OPTION 3



1

Ecological

Curated

Formal

3

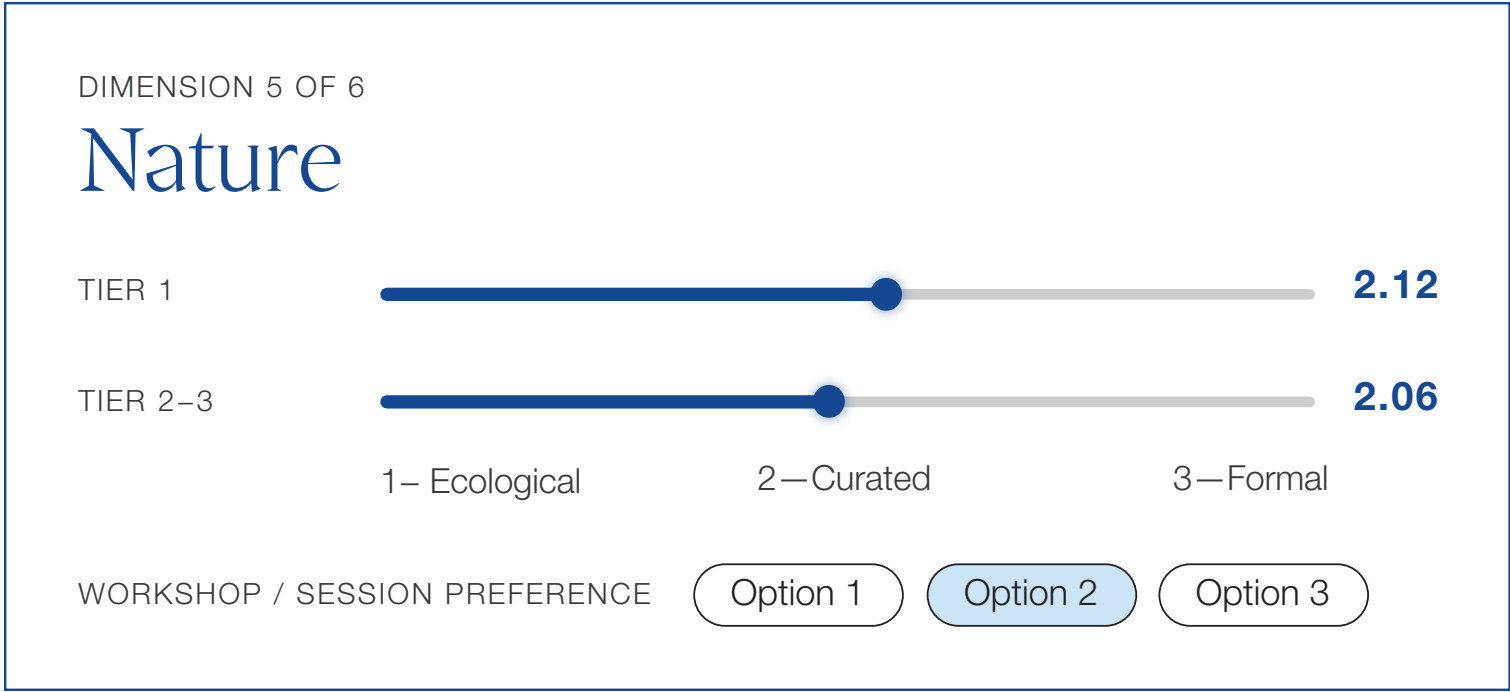

Key Takeaways

- Curated, organic, and flowing
- The meaning behind plant choices (cultural, symbolic, seasonal) should be intentional and communicated through an appropriate modality
- Participants shared the idea of layering elements and experiences, including more private areas for respite
- Native plants that thrive in Chicago conditions and create a sense of life year-round
- Plants that attract pollinators serve both ecological and cultural purposes, including butterflies, which carry meaning in the Latino community

It is important for it to feel organic and not overly planned. People want to feel comfortable and welcoming and purposeful but not overly structured.

Tier 2 Listening Session Participant

Memory Directions

OPTION 1



OPTION 2



OPTION 3



1

Ambient

Bold

Dynamic/Sculptural

3

DIMENSION 6 OF 6

Memory

TIER 1



1.81

TIER 2-3



1.75

1—Simple/Minimal

2—Narrative

3—Abstract

WORKSHOP / SESSION PREFERENCE

Option 1

Option 2

Option 3

Key Takeaways

- Names of the seven victims whose lives were taken in a simple yet profound approach
- Keep the seven as a recurring motif and as a symbolic anchor of design
- Abstract elements as an alternative to literal memorial forms

I don't know her favorite flower, but I know she loved to make the world more beautiful.

Tier 2 Listening Session Participant, speaking about a family member lost in the shooting

In Closing

This summary was prepared by [All Together](#) as part of the Highland Park Place of Remembrance design engagement process. All Together partnered with [SWA Group](#), the project's lead design firm, to facilitate Phase 1 engagement, synthesize community input, and translate the full range of voices heard across surveys, listening sessions, and the community workshop into themes and direction that can meaningfully guide SWA Group's concept development in Phase 2.

The perspectives gathered here represent 179 voices across all tiers of engagement, and they carry the weight of lived experience, ongoing grief, and deep investment in how this community chooses to remember. It is our collective responsibility as designers, engagement partners, and stewards of this process to honor what was shared with care and with fidelity as we move into the next phase of this work.

Questions?

Visit hpremembrance.org for more information,
or contact remembrance@cityhpil.com



Woven Together

A naturalistic garden framed by seven 'Remembrance Niches' is tied together with a gently meandering path and a babbling through-line of water.





Woven Together: Rose Garden Site Plan

Highland Park Place of Remembrance | Refined Concept Design | 06.08.2026

Woven Together (+ Water Feature)





Woven Together: Rose Garden Site Plan + Water Features

Highland Park Place of Remembrance | Refined Concept Design | 06.08.2026





Approach and Context

- The design is set back from St Johns but connected by a gentle, accessible path connecting to the street and City Hall.
- Upright maples and low screening hedges frame the Place of Remembrance to ensure low visual impact between the space and adjacent uses.

Woven Together: Walkthrough

Highland Park Place of Remembrance | Refined Concept Design | 06.08.2026

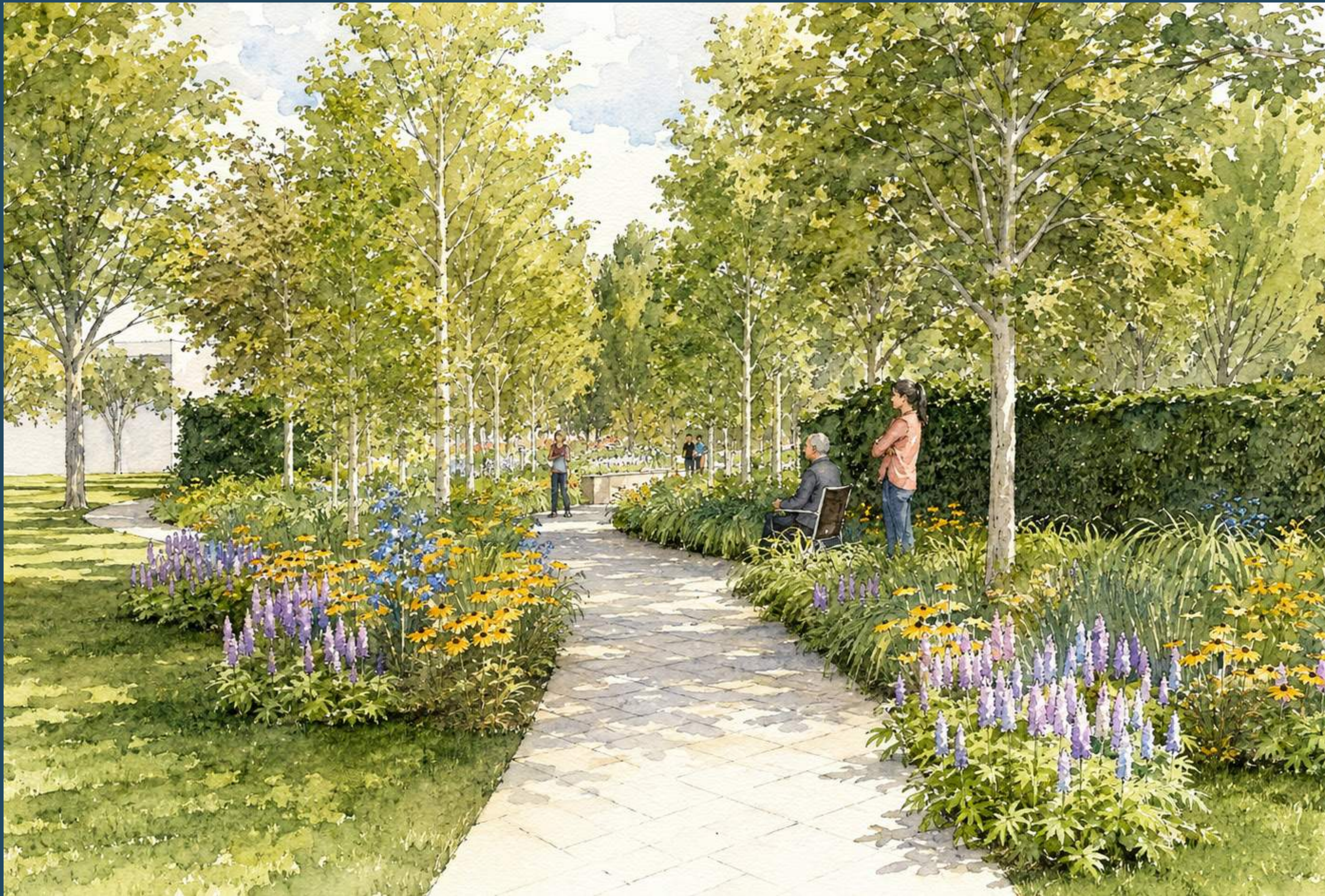

Entry Grove

- Aspen and lush understory act as a cool and calming threshold. Serene colors and foliage that responds playfully to the wind help visitors to relax.
- Stone entry signage welcomes visitors into the space.
- Planting compliments existing rainwater garden usage.

Woven Together: Walkthrough

Highland Park Place of Remembrance | Refined Concept Design | 06.08.2026



Entry Grove - Winter

Woven Together: Walkthrough

Highland Park Place of Remembrance | Refined Concept Design | 06.08.2026



The Council Ring

- The first space maintains the dimensions and formality of the historic Rose Garden.
- Narrative walls tell the story of Highland Park's resilience, the bravery of first responders and acknowledges the impact of the tragedy.
- The Council Ring allows for small scale gathering and honors the legacy of Jens Jensen who implemented similar elements to foster community.

Woven Together: Walkthrough

Highland Park Place of Remembrance | Refined Concept Design | 06.08.2026

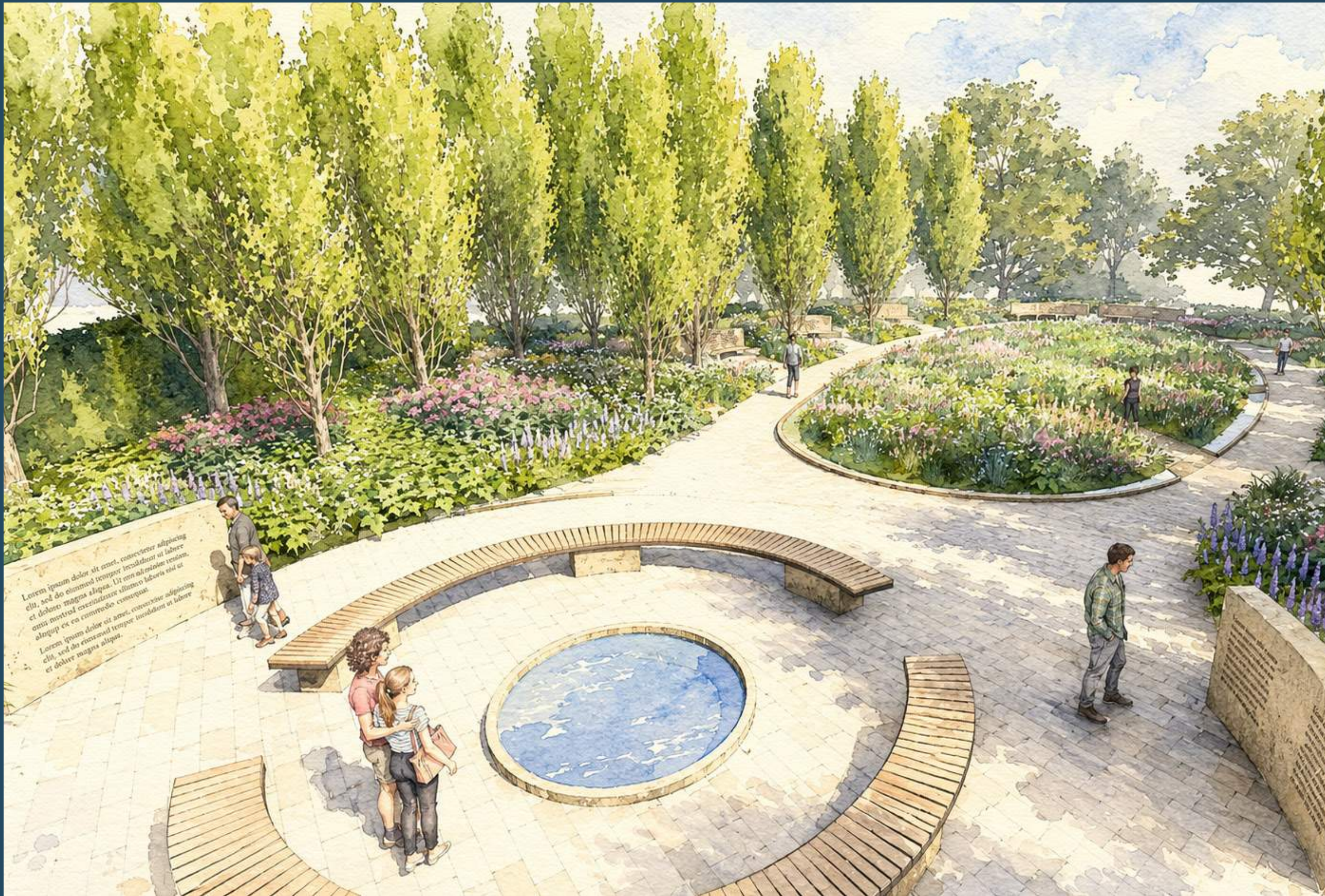

The Council Ring - With Water

- A reflection pool in the center invites visitors to sit before entering the garden beyond. The pool is similar to the original water feature installed in the Rose Garden and later removed.

Woven Together: Walkthrough

Highland Park Place of Remembrance | Refined Concept Design | 06.08.2026



The Reflection Garden

- The Reflection Garden features a walking loop and garden dedicated to the seven victims who lost their lives, framed by 48 upright maple trees representing those injured.
- Garden paths in the center weave the space together and allow visitors to feel immersed in planting.
- 7 niches extend off the path, inviting visitors to gather and reflect.

Woven Together: Walkthrough

Highland Park Place of Remembrance | Refined Concept Design | 06.08.2026



The Reflection Garden - With Water

- In addition to the niches and symbolic trees, the walking loop could be accompanied by a water feature framing the central garden and running towards the end of the space. The sound of water follows visitors like a companion walking along side them.

Woven Together: Walkthrough

Highland Park Place of Remembrance | Refined Concept Design | 06.08.2026

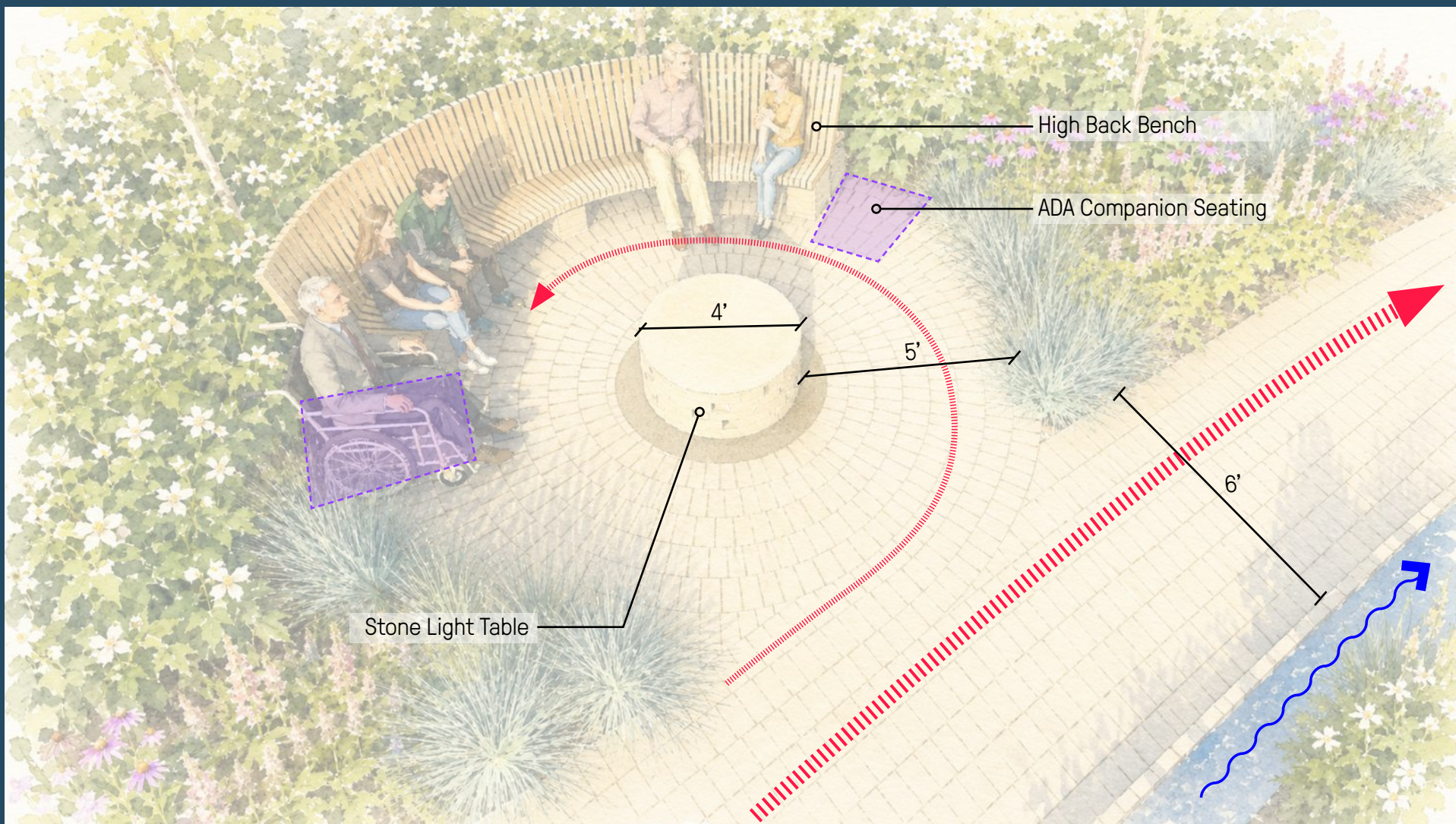
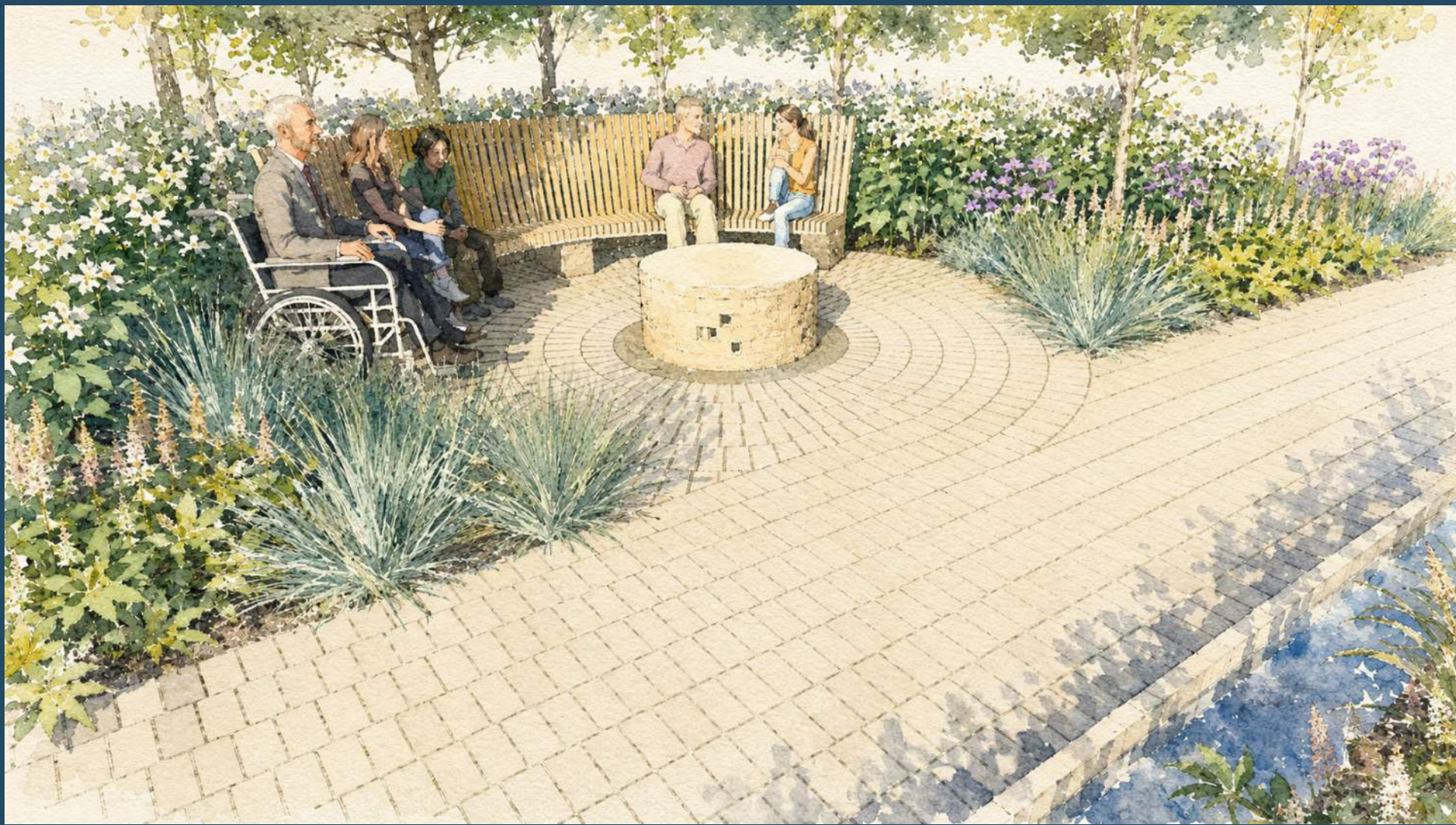

- Each niche features a stacked limestone table in the center. Small alcoves or shelves within the table allow light from a fixture within to pour out in a radial pattern.
- Brick pavers on the main path spiral off into each niche, evoking an eddy on the side of a stream.
- A high-backed wood bench creates a feeling of comfort and enclosure.
- The nearby water feature fills each space with calming sound.

Woven Together: Niche Design

Highland Park Place of Remembrance | Refined Concept Design | 06.08.2026



Reflection and Connection

- A wood clad bench with a high back embraces the end of the space, and allows visitors to sit and reflect, look out across the length of the garden.
- The names of the victims are inscribed on limestone panels against the backdrop of beautiful nature.

Woven Together: Walkthrough

Highland Park Place of Remembrance | Refined Concept Design | 06.08.2026



Reflection and Connection - With Water

- The water feature broadens at the low end of the loop into a calm reflecting pool, where limestone coping will host the names of the seven victims.

Woven Together: Walkthrough

Highland Park Place of Remembrance | Refined Concept Design | 06.08.2026



